

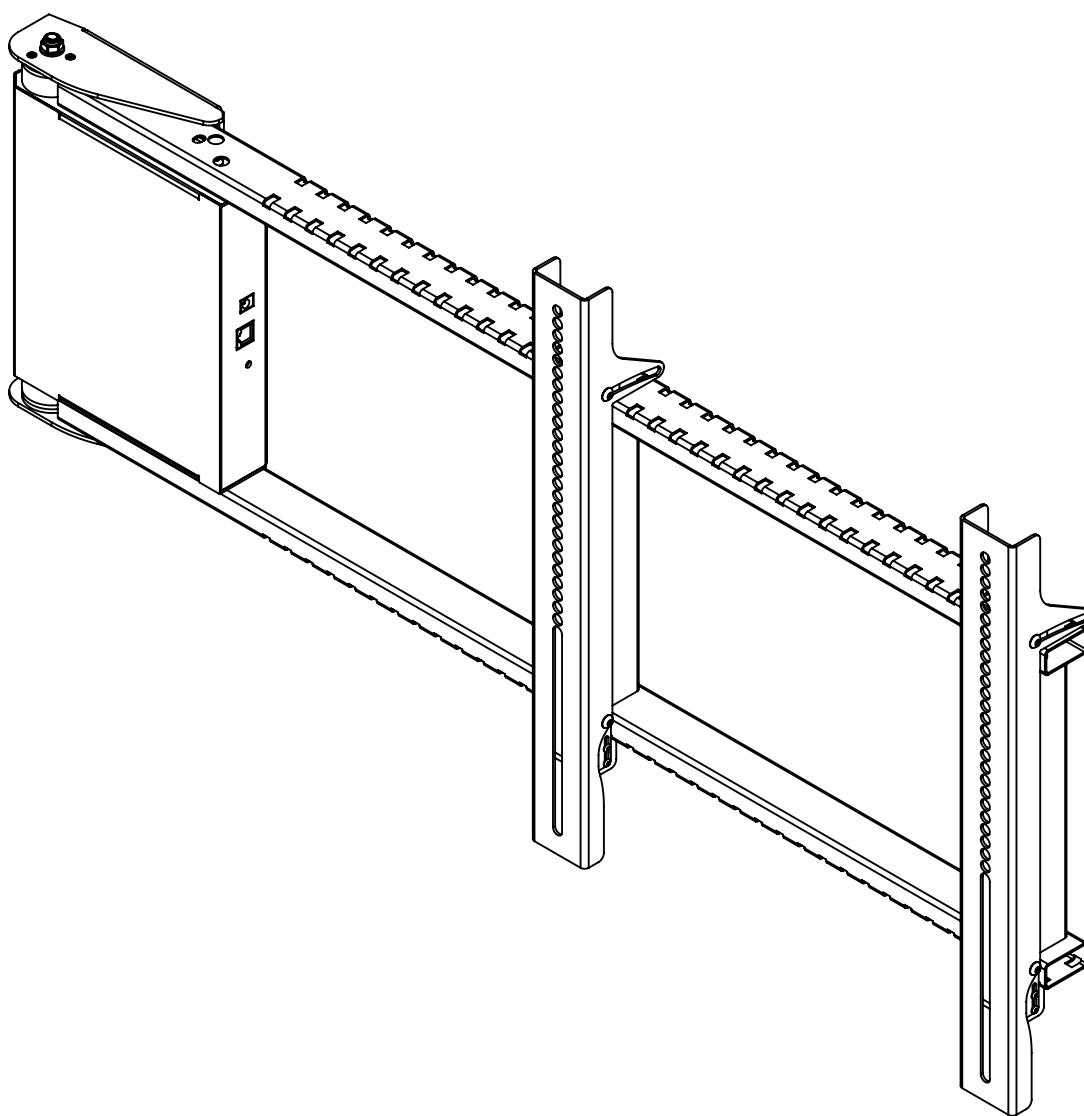

SWING MOUNT Mounting Instructions 1374



Parts List

Required tools

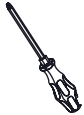

Screwdriver [1]

4x



Mounting screws,
depending on the
substrate [2]

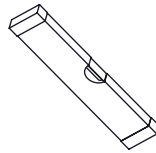

Spirit level [3]
*Not Required

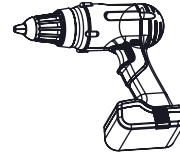

Drill driver [4]



Drill [5]
(Suitable for screws)

Supplied Accesories

1pc.

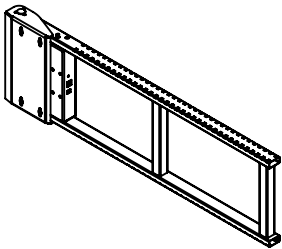

Swing Mount [6]

2pcs

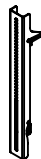

TV holder [7]

1pc.



IR Receiver [8]

1pc.

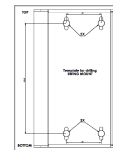

Template for drilling [8]

1pc.



AC adapter [10]

Pouch 1



- Allen key 3;
- Allen key 5;

Pouch 2

-spacers elements and screws for TV mounting



4pcs (15 mm)



4pcs - M5x25
4pcs - M8x25



4pcs - M4x25
4pcs - M6x25



4pcs (10 mm)



4pcs - washer 6

1.After unpacking, mount the vertical beams to the TV using screws supplied by the TV manufacturer, or optionally one of the included in the set (M4x25; M5x25; M6x25; M8x25). Optionally, use the supplied spacer elements to mount the TV**.

** Spacer Element



4pcs (15 mm)



4pcs (10 mm)

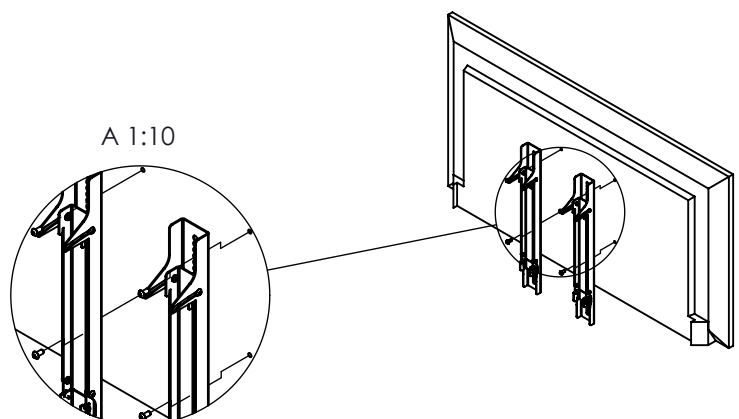

2. Mounting the device on the wall.

- 2.1. Apply the template, drill holes and mount the screws.
ATTENTION!
Remember to level the device.

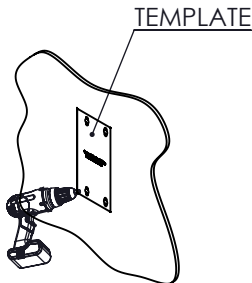

- 2.2. Put the SWING MOUNT and then move it down.
ATTENTION!
The device is symmetrical, mounting option for any opening direction (right-left).

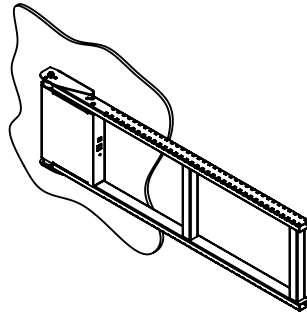

- 2.3. Open the device * and tighten the screws.
Attention!
Double check if the device is leveled using the provided spirit level (pic. a)

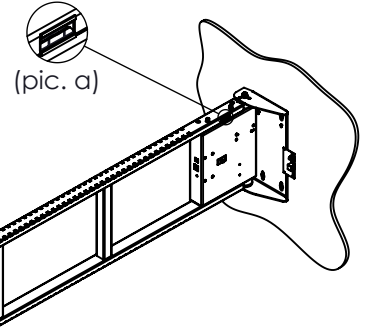

* Open SWING MOUNT manually or program the SWING MOUNT.
The device can be moved manually with no risk.

3. After mounting the device on the wall, hang the TV with previously installed vertical beams (see point 1) and then tighten the screws (detail D). Remember, however, that the TV mustn't protrude beyond the SWING MOUNT axis of rotation.

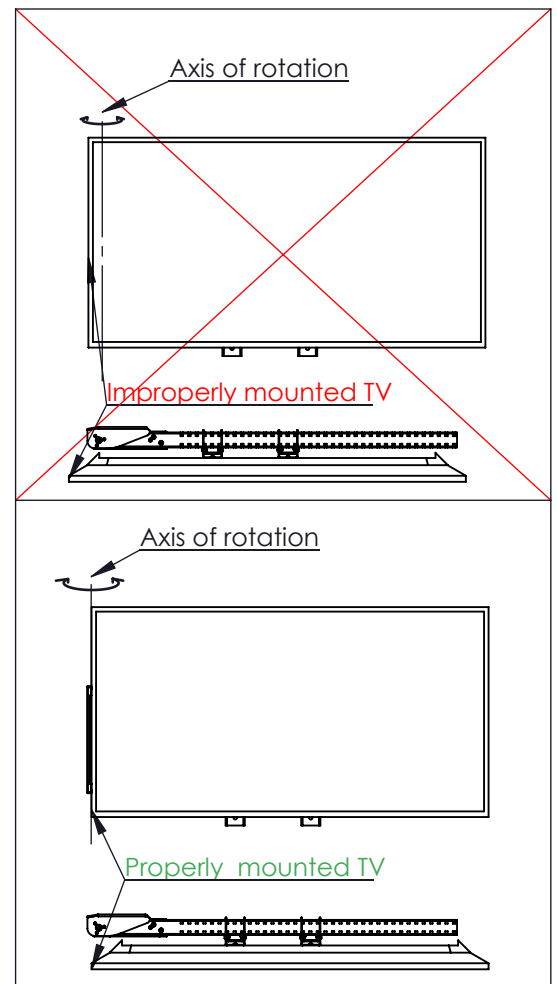
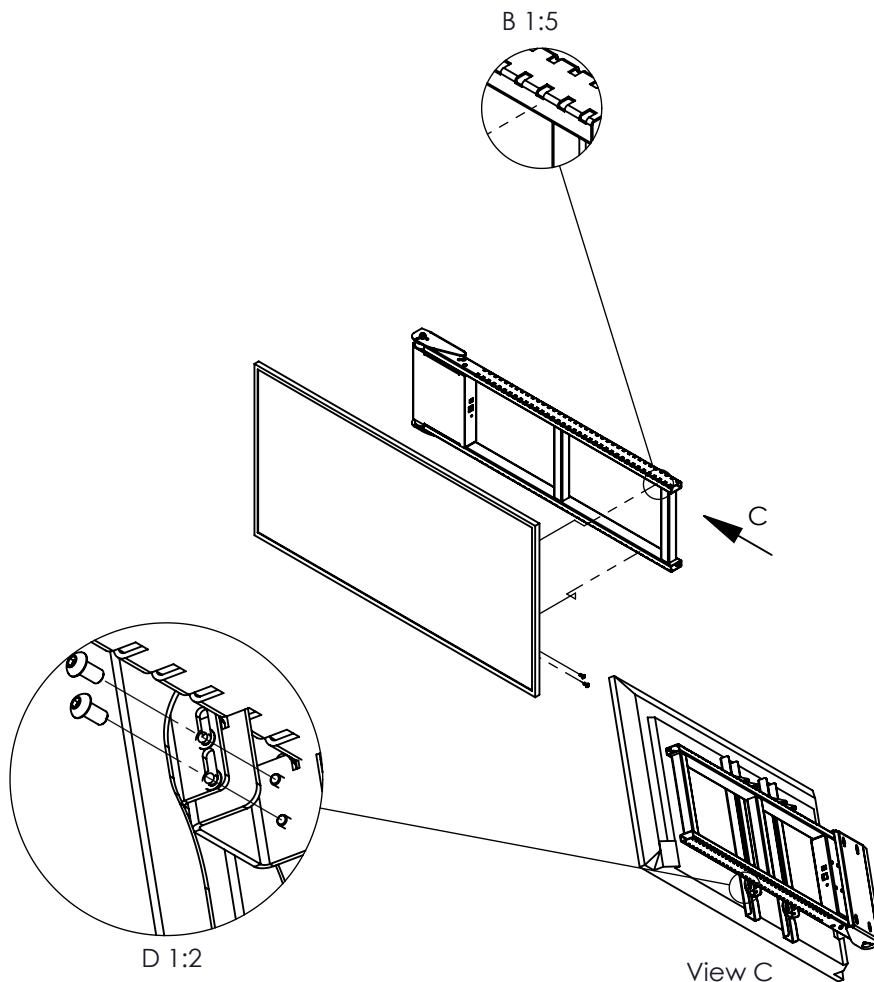

4. Adjusting the tilt angle.

Adjust the angle of inclination to comfortable to see the screen.

To do this, loosen the screws (detailed E), set accordingly screen then tighten the screws.

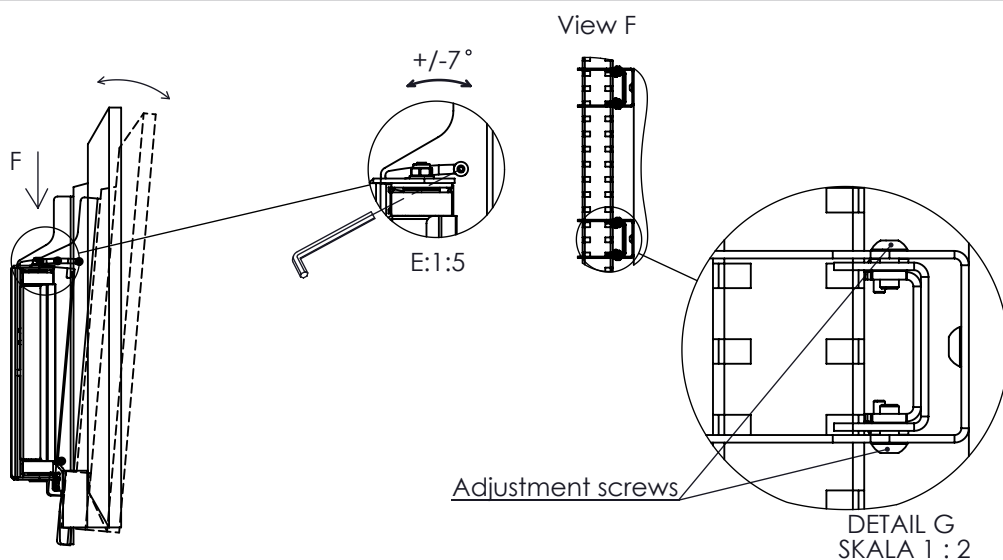

5. Connect the AC power adapter and IR receiver to corresponding sockets then connect the adapter to a power source.

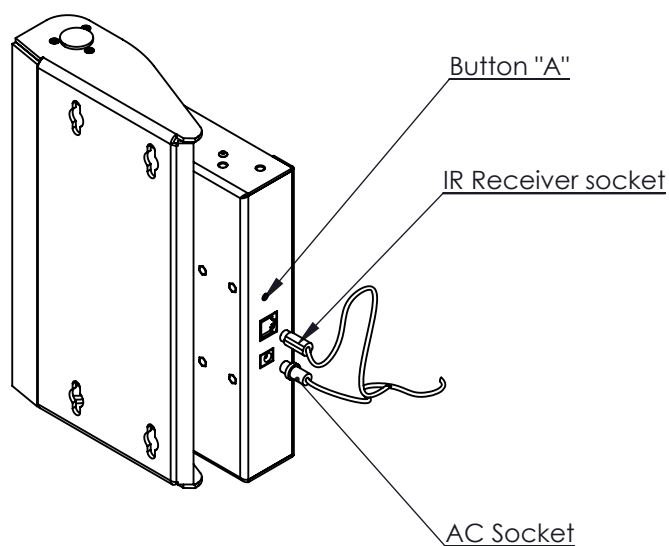

6. Place the IR receiver, so that it is visible to the remote control.

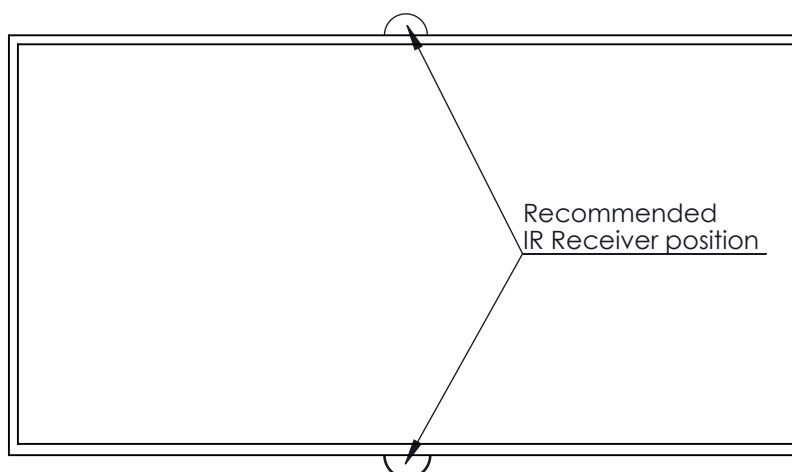

Driver programming SWING MOUNT

1. Connect the device to the power supply.

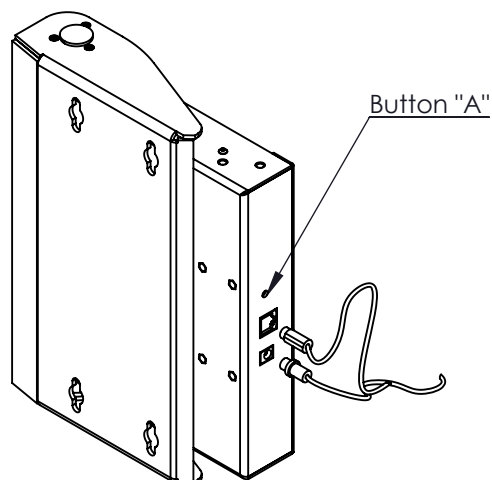

2. Programming begins by assigning specific functions to buttons on your remote control. The universal IR-Receiver can read most of the popular TV remotes.

Hold the "A" button on the Swing Mount until you hear constant sound signal "beep" then program the first button on your remote control.

After each "beep" signal, choose preferred button on your remote *.

- I - Opening button
- II - closing button
- III - setup button (set)
- IV - preferred position button
- V - full close button (reference)

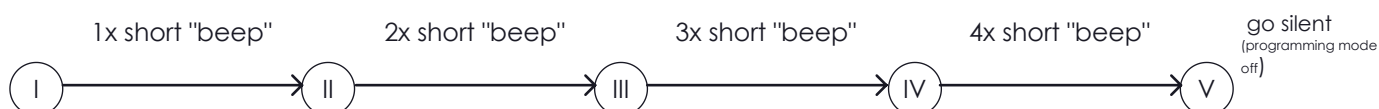
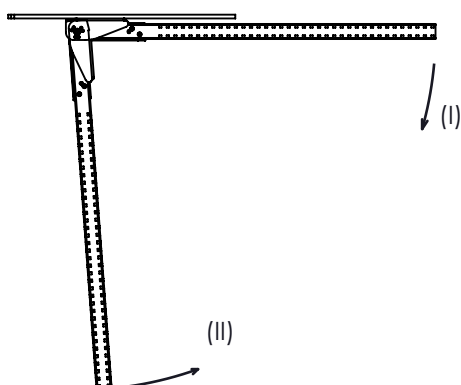

*Remember that this button will also be active for TV.

Driver notes

SWING MOUNT

1. After powering up the mount will signal its default closed position with 1 short sound signal (beep). This is a reference position. If the mount is not in this reference position, you will hear 3 short sound signals (3x beep) and mount will start to close - getting to its reference position.
2. After programming the remote 1 short "beep" signals accepting new preferred position (III)
3. 3x short "beep" signals an emergency stop due to blocking the mount's movement. After that the mount will try to get back to its reference position (closing)
4. To turn the sound signals off - apply this procedure :
 - a) press & hold the "A" button for about 6 seconds
 - b) within the 3rd second you will hear the continuous "beep"
 - c) after 6th second you will hear 3 short "beeps", which will acknowledge that the sound signals are off.
 - d) to turn back the sound signals simply unplug the unit from the power socket, and put it back again
5. Your Swing Mount device has an active RJ-45 Port, which can work with most of SABAJ accessories. Initially it is occupied with IR- receiver, but it can also work with smartphone adapter K-SMRT, or button control K-BTN. If you wish to have more accessories plugged - this is also possible with an RJ-SPLITTER accessory.
6. The Sabaj Accessories will activate only the preferred position (button IV) and closed, reference position (button V)
7. Some IR remotes generate different IR signals within consequent pressing of a button. In those events, only every second pressing of a button will make Swing Mount operational. This might come across as loss of control of your unit. In those particular cases it is recommended to use different buttons on your remote.

Sample TV remote control setting

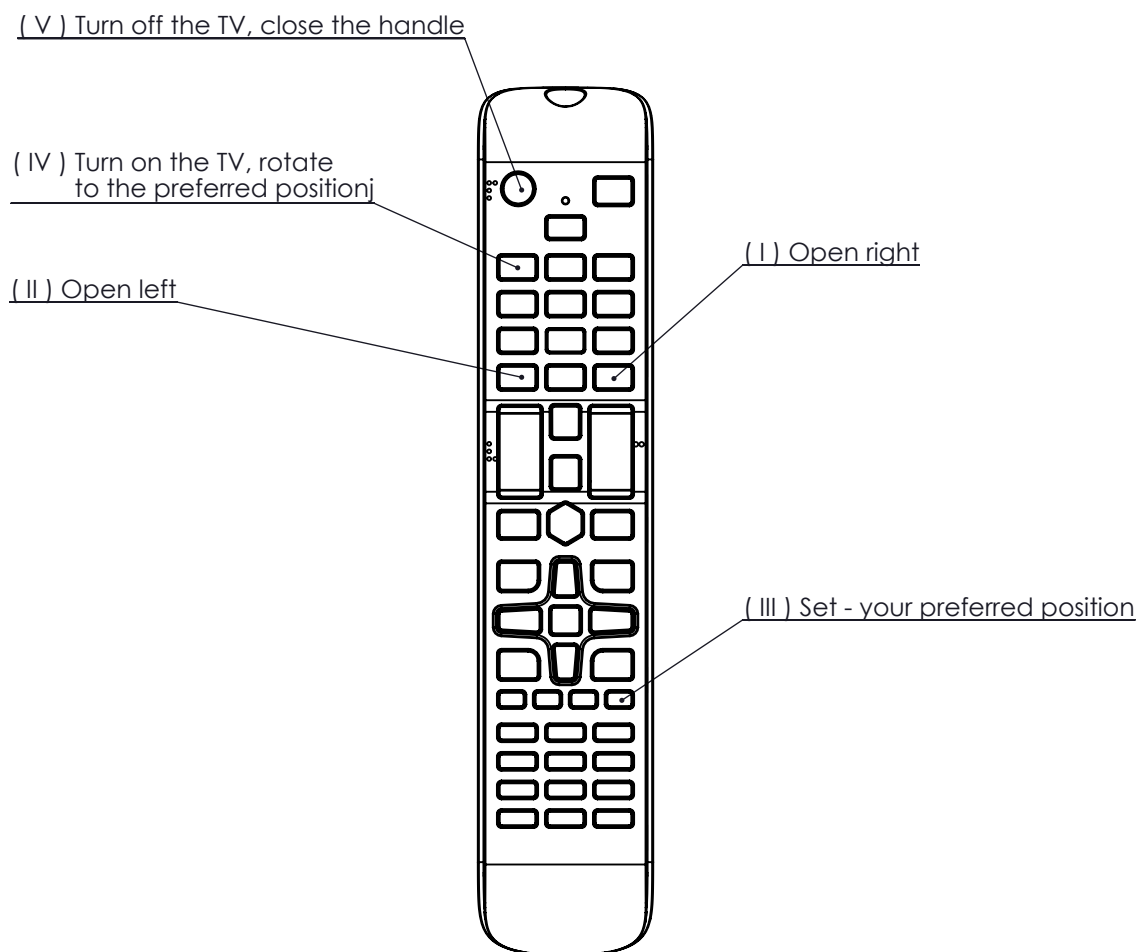

*The above picture is just an example - SWING MOUNT can be programmed according to your preferences

3. Preferred position:

- set the device position using the (I) and (II) buttons and confirm with the (III) button, until you hear a short beep. From now on, the button assigned as (IV) will set the handle to the programmed position.

4. After step (V) programming is done. You may also leave the programming mode anytime you want by pressing the "A" button on the Swing Mount.